

REFEREE HELP GUIDE

Step 1. Download the App

IOS App Store - <https://apps.apple.com/us/app/squadi/id1614546003>

Google Play - <https://play.google.com/store/apps/details?id=com.wsa.squadi>

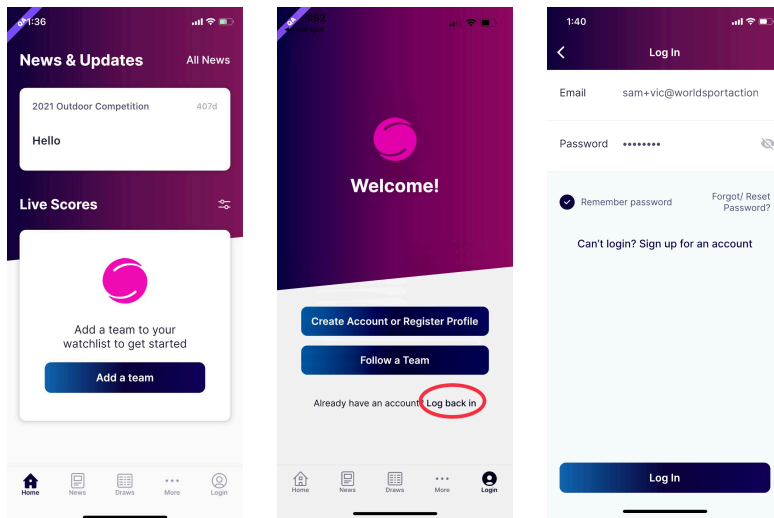

Step 2. Once logged in you should see matches on the home screen with the label 'Scoring'

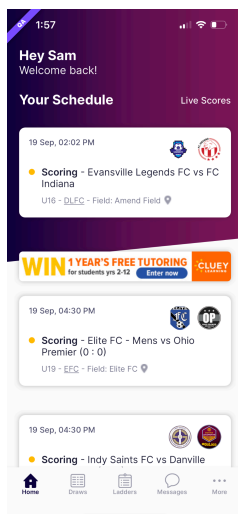

Step 3. Prior to the match start select the match you are refereeing, here you will see the caution 'Team Sheet Not Set' if the the Teams have not completed their roster.

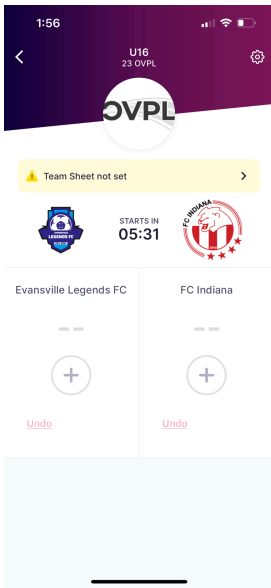

To complete the roster on behalf of either team you can select this caution or the settings icon you can then complete the roster by ticking the appropriate players

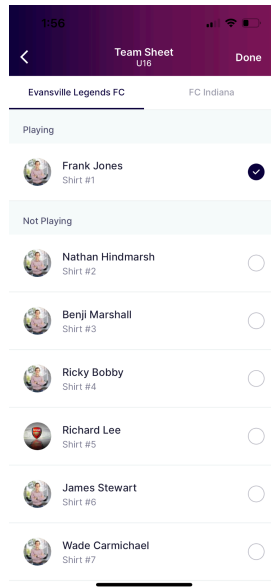
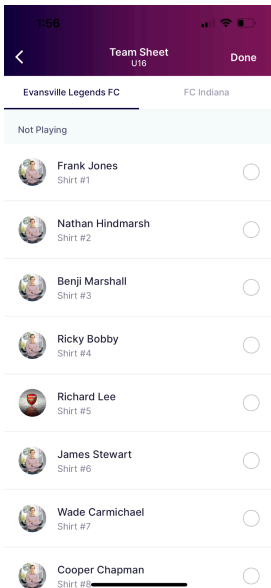

Step 4. Entering the results live - Once the Match has started you can enter the information realtime. Select the '+' then select the type of action then the player. **NOTE if you want to enter the results after the match DO NOT CLICK START.**

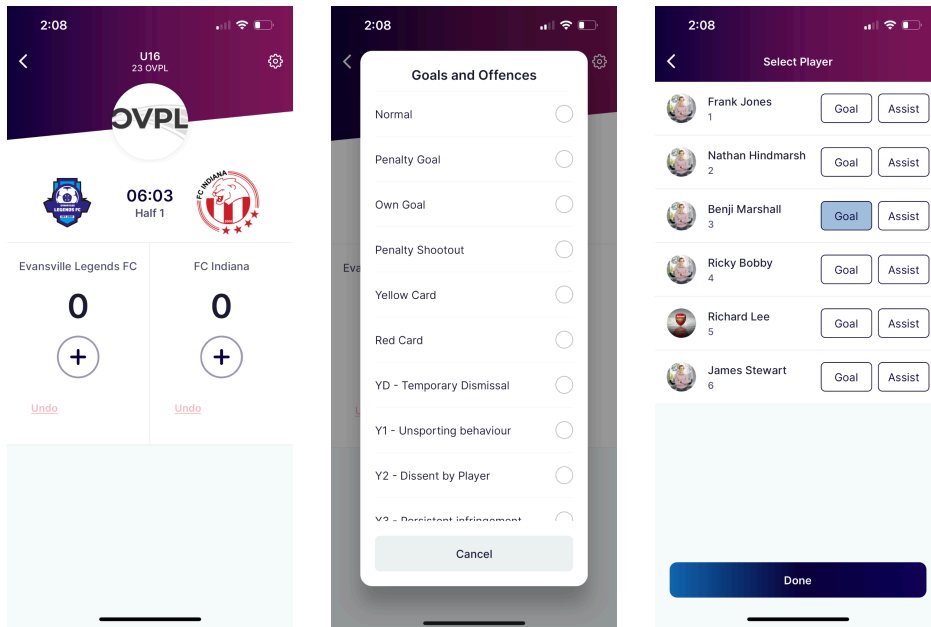

Step 5. Entering the results after the match - at the conclusion of the game tap on the referee card then;

click the 'Timeline +' and enter either the foul, goal or substitution by player. Once completed click 'Verify' this match will then remove from your schedule.

